



progression in suspension

Dear Powerflex Partner,

NEW PRODUCT RELEASE

PFR46-204G - UPPER CONTROL ARM/RADIUS ARM-INNER/OUTER
- CAMBER ADJUSTING BUSH

Vehicle applications, (always refer to catalogue for current listings)
Nissan Silvia, 180SX,200SX,240SX - S13,S14,S15.
Nissan Skyline GTS,GTt,GTR - R32,R33,R34
Nissan 300ZX,Fairlady - Z32

PFR46-204G bush comes from the range of **Geometry Adjustment Components (GAC)** available from **Powerflex**.

PFR46-204G has been designed to complement the existing range of bushes, now giving two options;

- PFR46-204 - standard replacement bush
- PFR46-204G** - **CAMBER adjustable replacement bush**

PFR46-204G has been engineered to allow ON-CAR CAMBER adjustment for the rear suspension, with a designed adjustment range of +/-1.5 deg.

THE PROBLEM...

Average static rear camber setting on standard cars listed above is around -1.75 deg, and with very minimal factory adjustment available, it is difficult to obtain ideal geometry. The multi link suspension layout with aggressive camber gain further exacerbates this problem on cars with even a mild lowering of around 1" by increasing the static camber angle to around -2.5 deg causing;

- poor handling
- reduced tyre grip
- increased tyre wear
- reduced tyre contact patch

All of the above issues are magnified yet again during acceleration or cornering, i.e. when good grip is needed the most.

THE SOLUTION...

Fitting a set of **PFR46-204G** bushes allows for on car adjustment of the rear camber. With +/-1.5 degrees of adjustment range available, the excessive camber can be reduced to appropriate setting, achieving the following improvements;

- improved handling
- increased tyre grip
- reduced tyre wear
- increased tyre contact patch

On-car adjustment is easily achieved via a castellated offset stainless steel centre sleeve and the C'Spanner supplied. Once assembled onto the car the camber angles can be set quickly without the need to remove the arms again.

Until next time, the Powerflex Team.

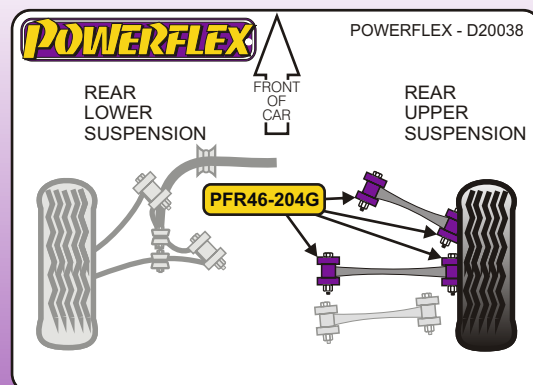
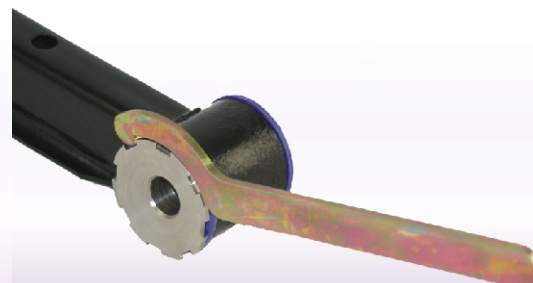

EPTG Ltd - POWERFLEX
7 Union Buildings
Wallingford Road
Uxbridge UB8 2FR
United Kingdom

Tel: +44 (0) 1895 460033
Fax: +44 (0) 1895 520095
E-mail: sales@powerflex.co.uk
Web site: www.powerflex.co.uk

