

POWERFLEX®

PART NUMBER

PFF46-702G

DESCRIPTION

FRONT WISHBONE REAR BUSH ANTI-LIFT & CASTER OFFSET

INSTALLATION GUIDE

Contents (parts per pack):

- 2 x Aluminium brackets fitted with polyurethane bushes
- 2 x Anodised Aluminium sleeves
- 2 x Self-aligning bolts
- 2 x Washers
- 1 x PTFE / Silicone Bush Assembly Grease

Please read the complete fitting instructions and check package components before fitment. These fitting instructions are to be used as a guide and in conjunction with workshop manual. It is recommended that:

- all work to be carried out by a licensed technician;
- all safety precautions adhered to;
- wheel alignment to be checked and adjusted as required after any suspension work.

All fasteners must be tensioned to manufacturer's torque settings.

Fitting Instructions:

1. Remove wishbones from the car and remove the original rear bush mounting bracket and bush from the wishbone.
2. Clean any dirt and corrosion from the end of the wishbone and press the anodised aluminium sleeve onto the end of the wishbone with the largest diameter of the sleeve being pressed onto the arm first. Apply pressure until it meets the end of the arm. **Note: it is recommended to heat the anodised aluminium sleeve between 60-80°C before fitting to provide a good interference fit, allow to cool before fitting into the bush**
3. Apply the supplied PTFE / Silicone grease to the bore of the bush and insert the wishbone with sleeve fitted into the corresponding bush and bracket assembly with the smallest diameter of the sleeve fitting into the stepped section of the bush first. **Note: the brackets and bushes are left and right handed and will only fit onto the car in the orientation shown below.**
4. Re-fit the arm to the car and loosely fit the original long inner mounting bolt, followed by the smaller self-aligning bolt (supplied). Tension all hardware to manufacturers recommended torque settings.



Sleeve sits against shoulder on arm

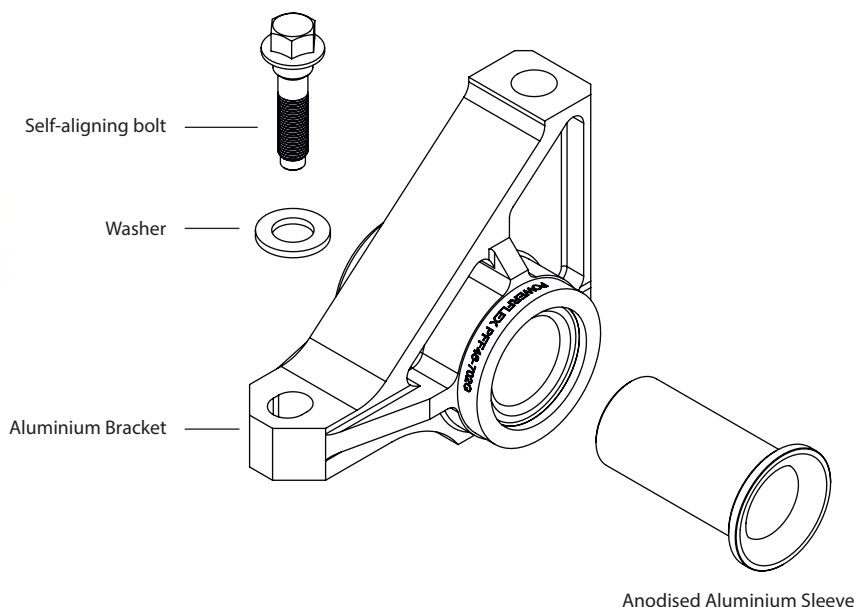

Bracket fitted to left hand arm.



Bracket fitted to right hand arm.